



## Product Announcement

### *NEAPCO® Aluminum Un-Welded Driveshaft Assemblies*

1330, 1350, 1410 Series — 3 ½ & 4 inch tube diameters  
*Each Packaged Assembly includes 2 Weld Yokes and a length of Tubing.*



NEAPCO announces the availability of four New Aluminum Un-welded Driveshaft Assemblies. This new product broadens the product offering for the driveline specialist and provides for expanded fabrication of aluminum applications to replace an aluminum driveshaft. These yokes are manufactured from 6061-T6 and the tubes are 6061-T62 seamless drawn tubing and are used in various OE applications. All four weld yokes included in this product offering are 3.90 inches center line of U-joint to weld point. The common center line will minimize change over time when going from series to series and from 3 ½ to 4 inch tube diameters.

*Please see the reverse side for part numbers and specification*

*NEAPCO Components, LLC 740 Queen St. Pottstown, PA 19464*

Phone: 800-821-2374

E-mail: [hd@neapco.com](mailto:hd@neapco.com)

©2010 NEAPCO Components, LLC

***Innovative Drivetrain Solutions™***

9901184

Fax: 610-326-2002

Web site: [www.neapco.com](http://www.neapco.com)

04/2010

1



*New Aluminum Un-Welded  
Driveshaft Assembly Part Numbers*

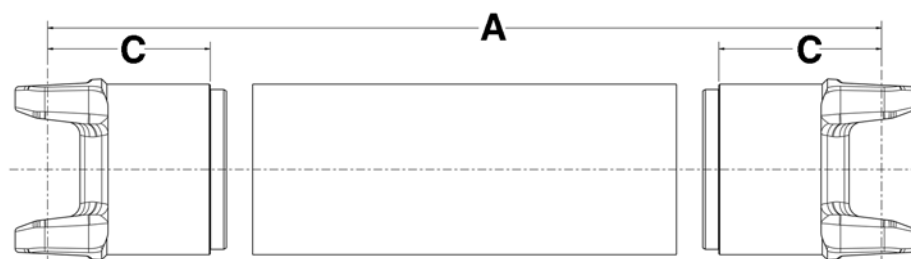

<b>Series</b>	<b>A Max. Length CL to CL</b>	<b>Tube Size</b>	<b>C CL to weld point</b>	<b>Part Number</b>
<b>1330</b>	55.30	3.50X.114	3.90	<b>A133-4800-3.5</b>
<b>1350</b>	55.30	3.50X.114	3.90	<b>A135-4800-3.5</b>
<b>1350</b>	71.20	4.00X.087	3.90	<b>A135-6500-4</b>
<b>1410</b>	71.20	4.00X.087	3.90	<b>A141-6500-4</b>