



# Product Enhancement

## Center Support Modification

Neapco center support part numbers N211016X, N210866-1X & N210873-1X have been updated to reflect the current OE design. The flared diametrical lip that appears on one side only is now on both sides. This change will eliminate the slinger clearance issues that existed on some applications.

**Old Version**

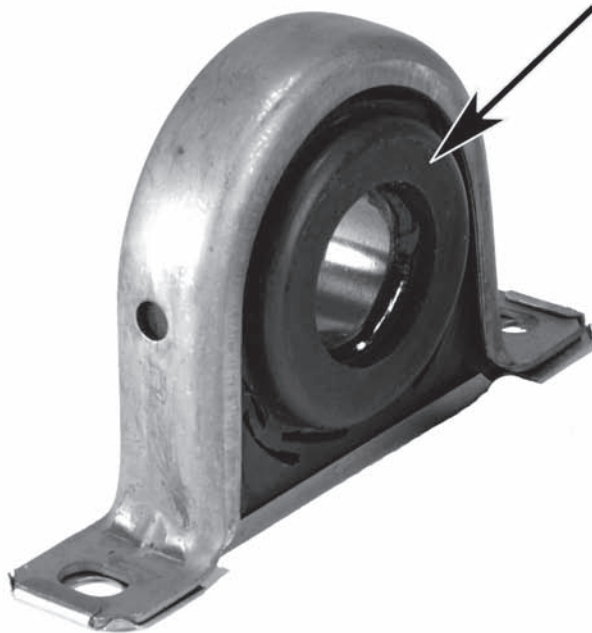

**New Version**

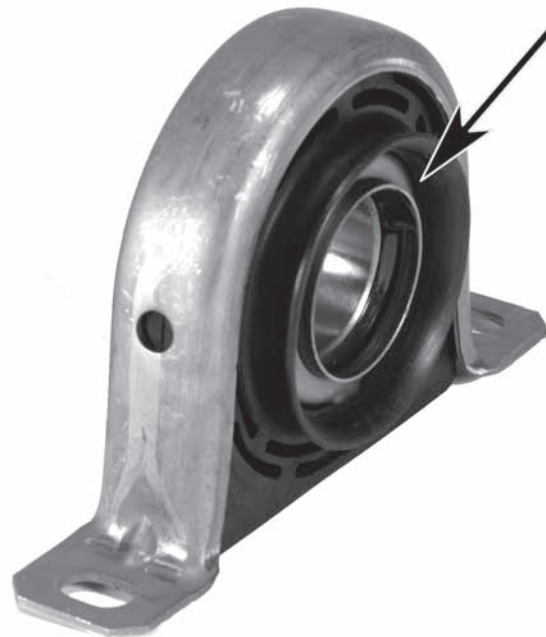

NEAPCO INC. 740 Queen St. Pottstown, PA 19464

*Innovative Drivetrain Solutions*

Phone: 800-821-2374  
E-mail: [hd@neapco.com](mailto:hd@neapco.com)  
©2006 Neapco Inc.

( Insert this sheet into  
Section XI in the  
DS245 Master Catalog )  
9901020

Fax: 610-326-2002  
Web site: [www.neapco.com](http://www.neapco.com)  
04/06 1