

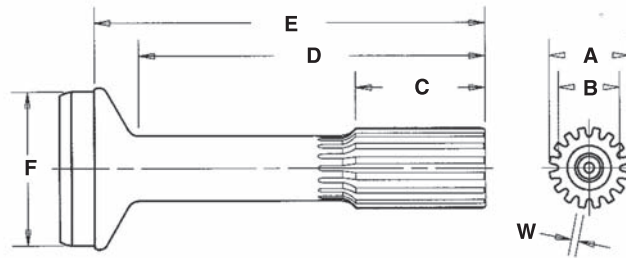

# Product Announcement

## New Slip Stub Shafts with Dura-Slip®



**Note:** Some non-Neapco driveline tubing sizes will require that dimension "F" (butt diameter) be reduced for proper tubing interference. Machine the butt diameter .008" to .012" greater than the inside diameter of the tube.

Spline Data			C Length of Spline	F		D End of Spline to Radius	E End of Spline to Weld	Stub Shaft Part Number
A Major Diameter	B Minor Diameter	W Tooth Width		For use with Tubing Diameter & Wall	End of Butt Diameter			
1.375 - 16 Spline								
1.375	1.172	0.125	2.25	2.00X.083	1.844	6.12	6.69	N2-40-1841-1

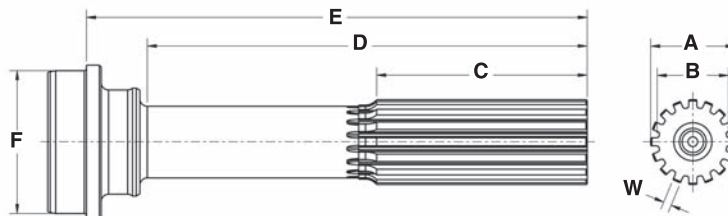

**Note:** Part accepts boot for slip and stub assembly

Spline Data			C Length of Spline	F		D End of Spline to Radius	E End of Spline to Weld	Stub Shaft Part Number
A Major Diameter	B Minor Diameter	W Tooth Width		For use with Tubing Diameter & Wall	End of Butt Diameter			
1.375 - 16 Spline								
1.375	1.172	0.125	3.38	2.50X.095	2.320	7.12	8.12	N2-40-2791-1

NEAPCO, LLC 740 Queen St. Pottstown, PA 19464

*Innovative Drivetrain Solutions*

Phone: 800-821-2374  
E-mail: [hd@neapco.com](mailto:hd@neapco.com)  
©2006 NEAPCO, LLC

( Insert this sheet into  
Section VII in the  
DS245 Master Catalog )  
9901079

Fax: 610-326-2002  
Web site: [www.neapco.com](http://www.neapco.com)  
07/06 1